

# Installation of Assa cylinder in Fermob lock- 620

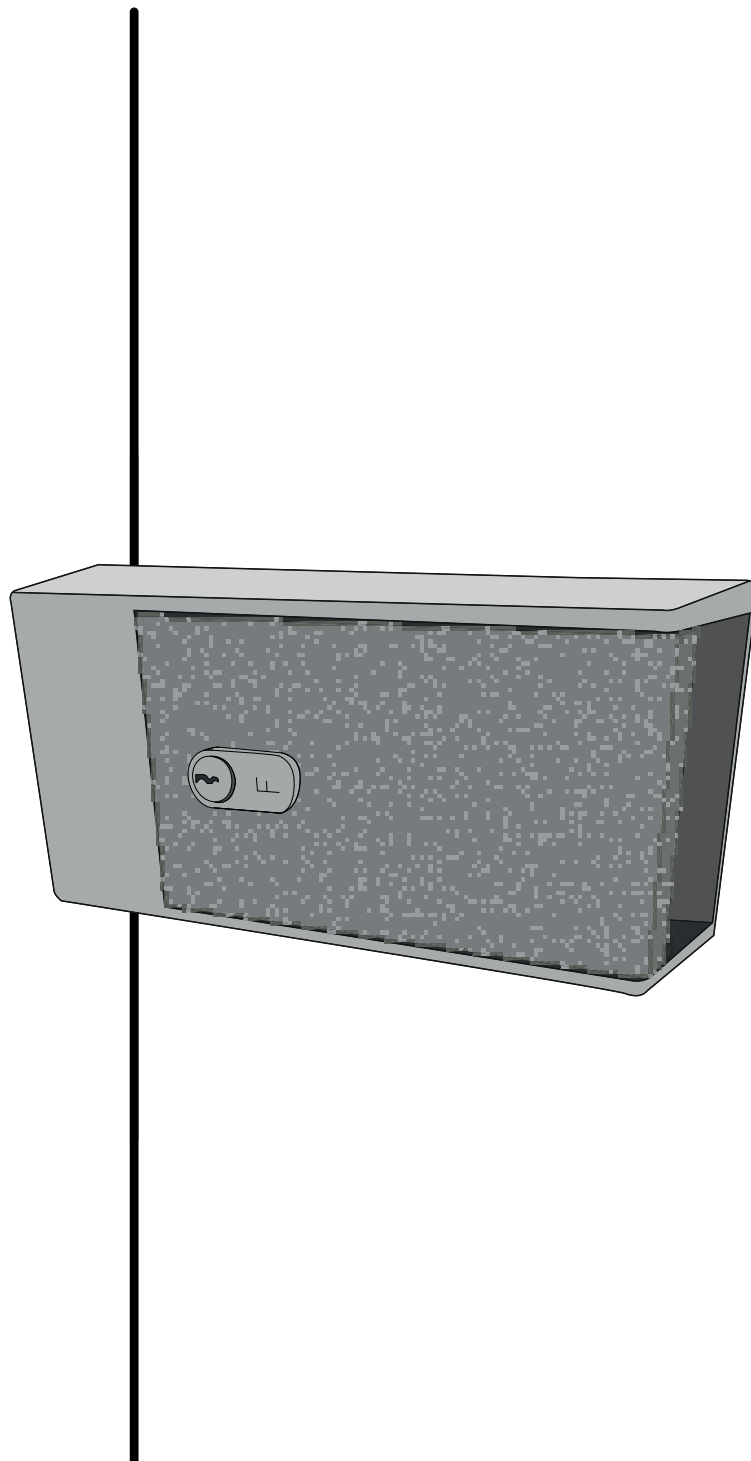

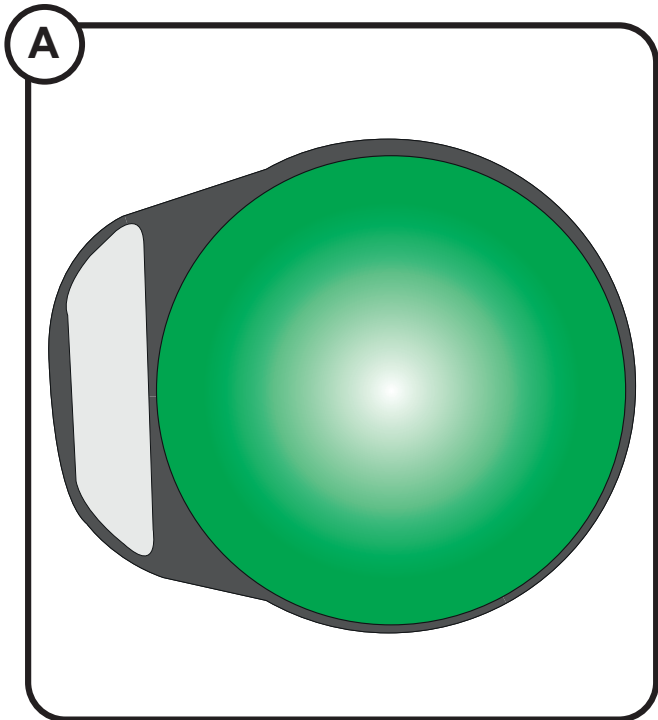

**A**  
Loosen the green rubber cover.

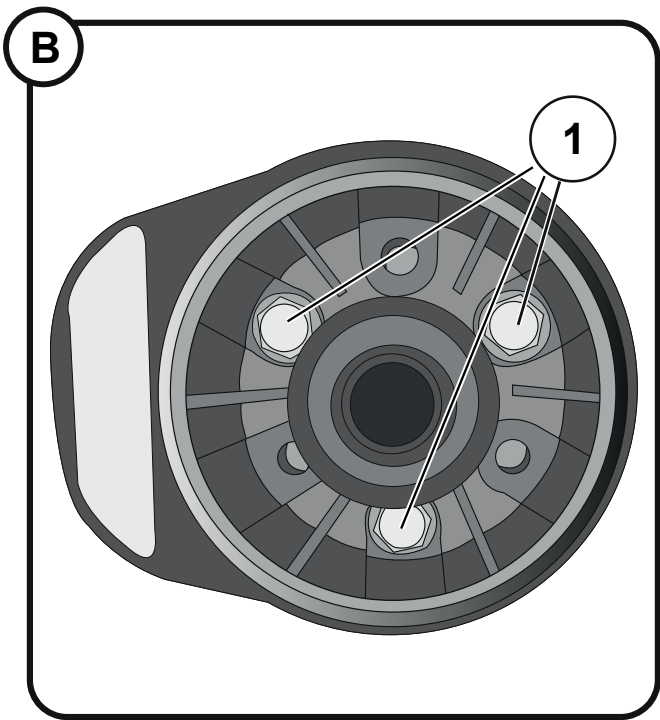

**B**  
Unscrew the 3 screws (1) with socket 10 mm.

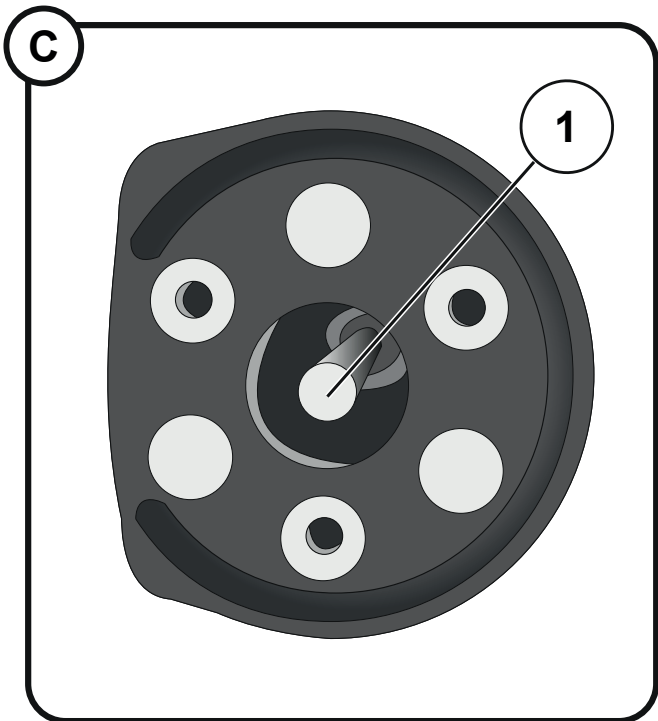

**C**  
Remove the plastic stick (1).

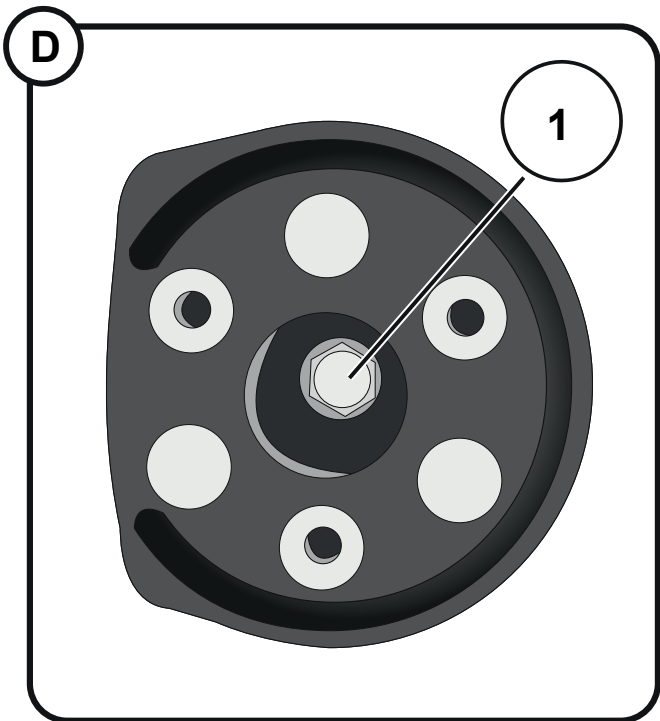

**D**  
Unscrew the screw (1) with socket 17 mm.

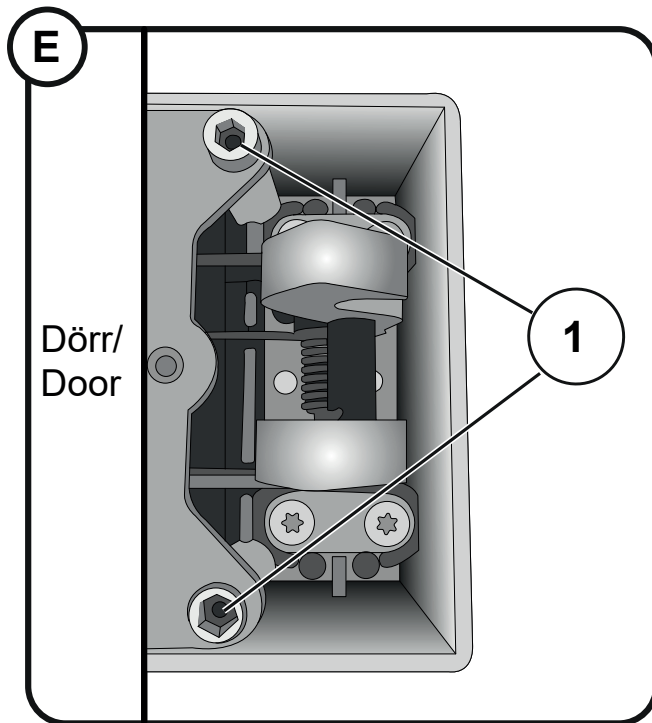

**E**  
Unscrew the screws (1) with  
5 mm hex key.

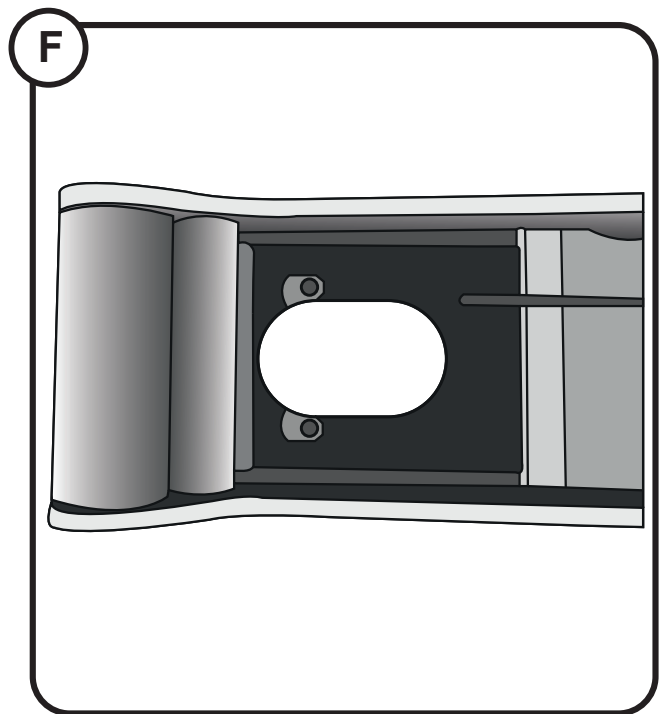

**F**  
Inside of the lock.

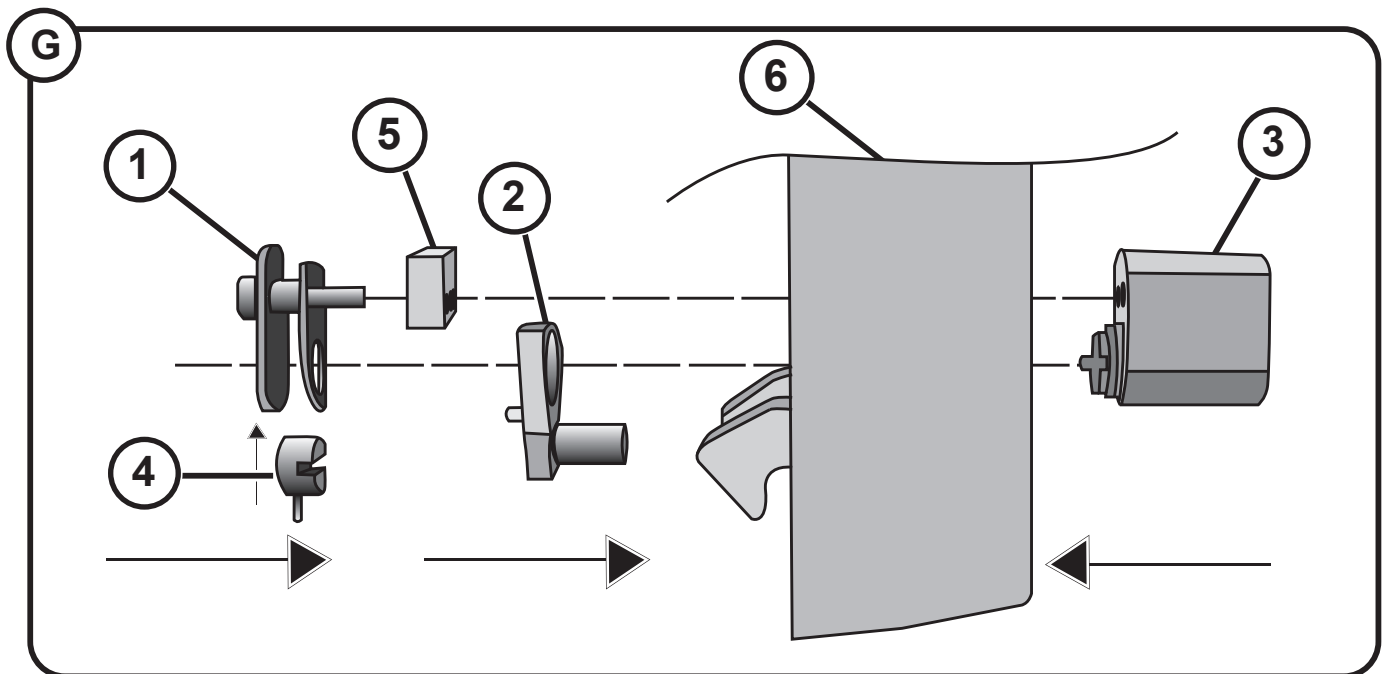

**G**

1. Insert the lock cylinder (3) halfway into the handle.
2. Detail (2) is set in position on the lock cylinder (3).
3. Put together detail (1) and (5).
4. Screw part (1) and (5) into the lock cylinder (3). Dont screw to max.
5. Insert detail (4) of the lock cylinder (3). Make sure the wedge is correctly positioned in the groove.
6. Tighten the screws on detail (1).
7. Tighten the screws and spacers on detail (5).
8. Make sure the locking element moves correctly when the key is turned.

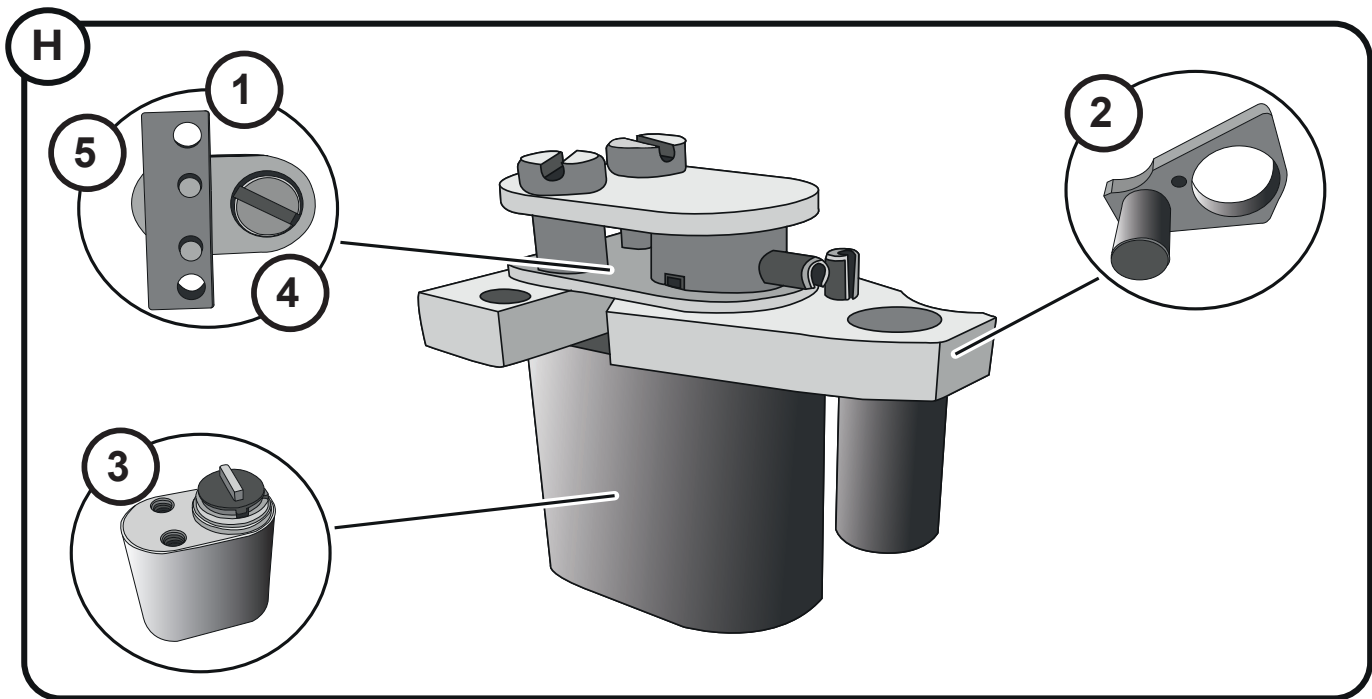

H  
Overview of the cylinder assembled with its carriers.

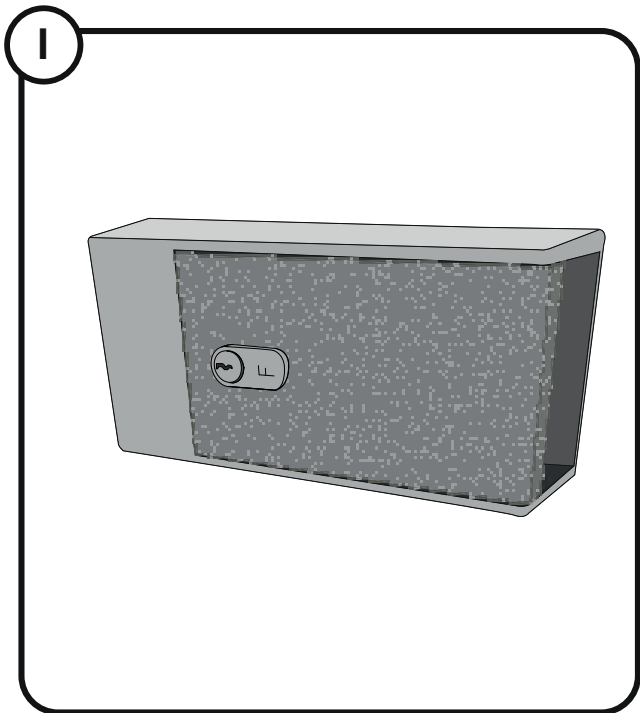

H  
Mount the lock on the door.