

## Installation of heating wire in cold room door KD with FD frame

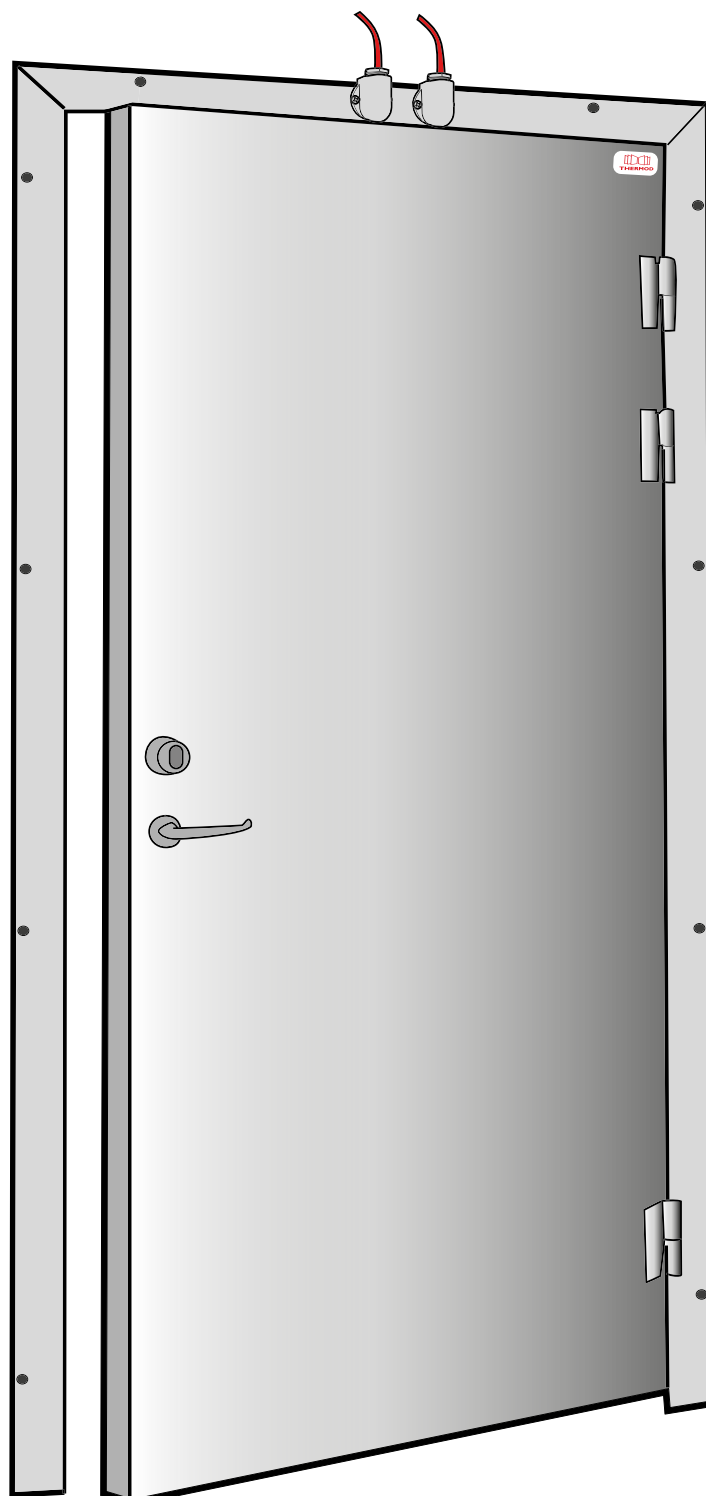

**This installation is only possible if the door frame is prepared with a track for a heating cable.**

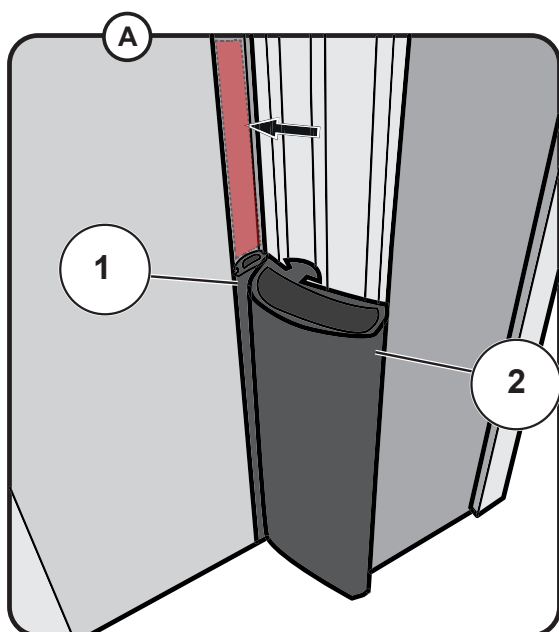

A. The heating cable shall be installed behind the covering seal (1). Before installation, remove both the covering seal and the seal (1),(2).

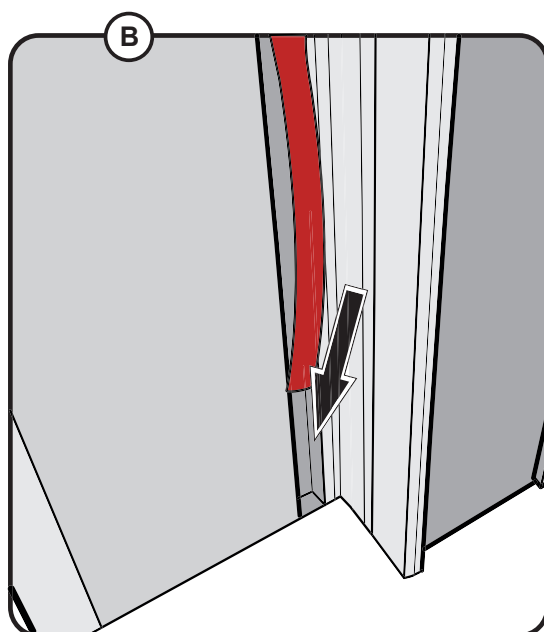

B. When installing the heating cable, make sure that the end of the cable is attached to the bottom doorframe.

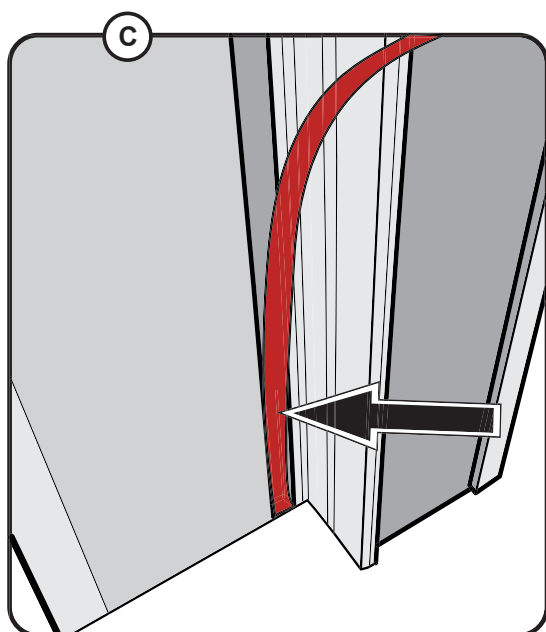

C. Press the heating cable gently inwards all the way up. Repeat on the other side.

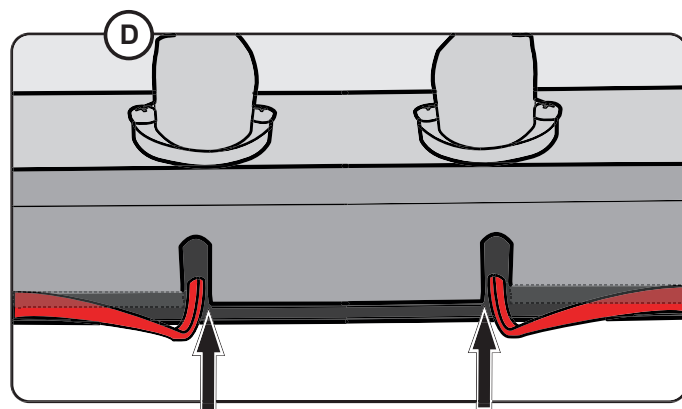

D. The heating cables shall be put into the cable tracks at the upper doorframe.

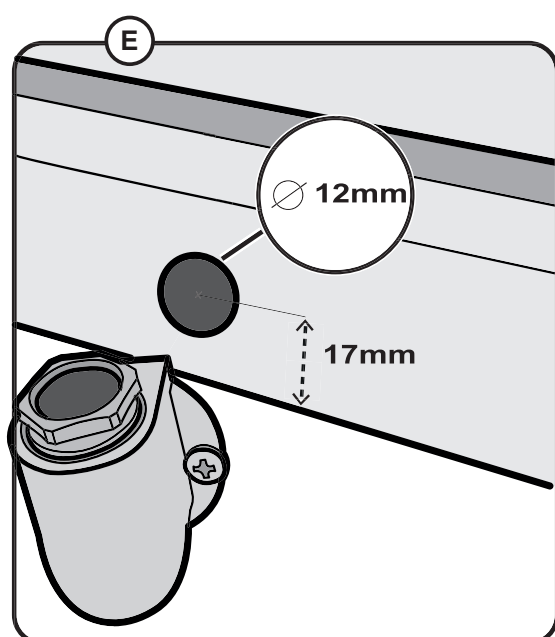

E. Drill a 12 mm hole, 17mm up from the edge of the upper doorframe above both of the cable tracks to each of the conduit entry.

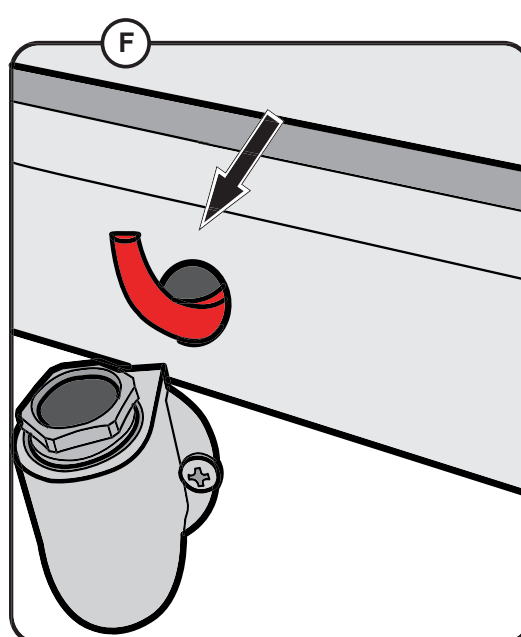

F. Insert the heating cable through the drilled hole and through the conduit entry.

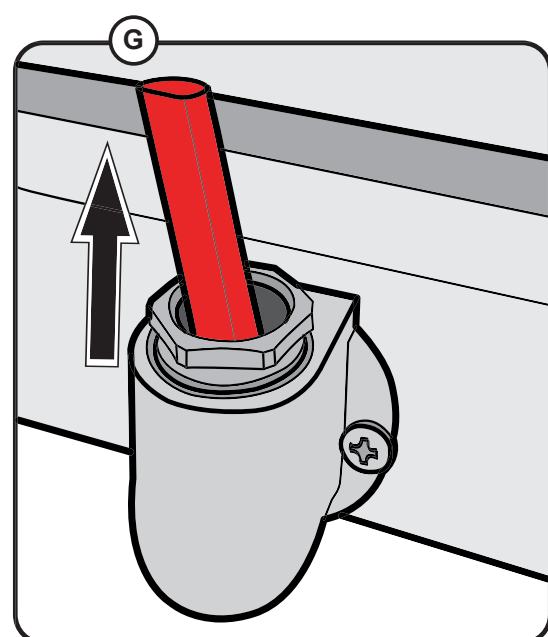

G. Attach the conduit entry to the upper doorframe.

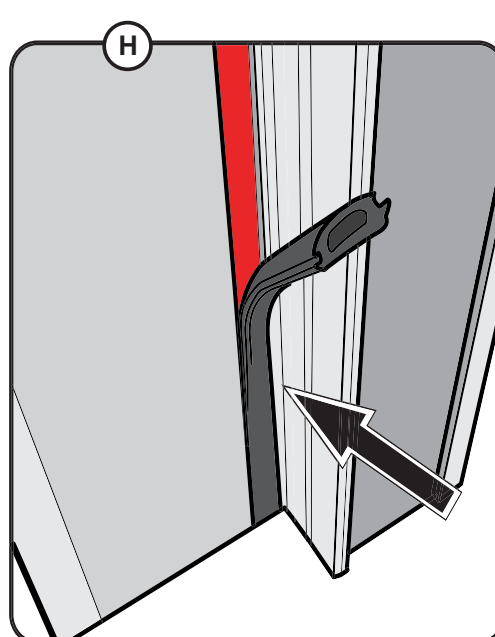

H. Install the covering seal in front of the heating cable. Start from the bottom up. Attach by pressing inwards.

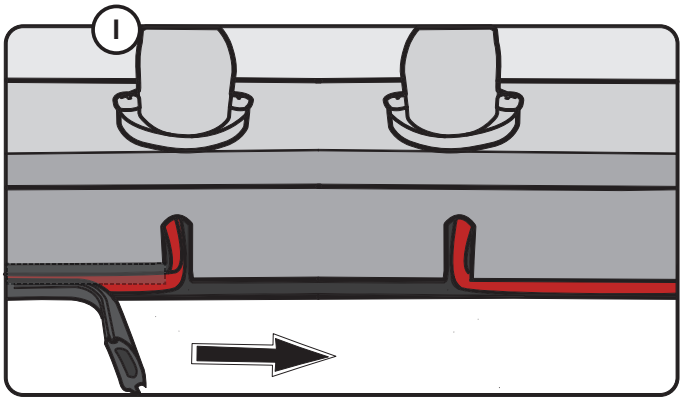

I. The covering seal shall be installed along with the whole doorframe.

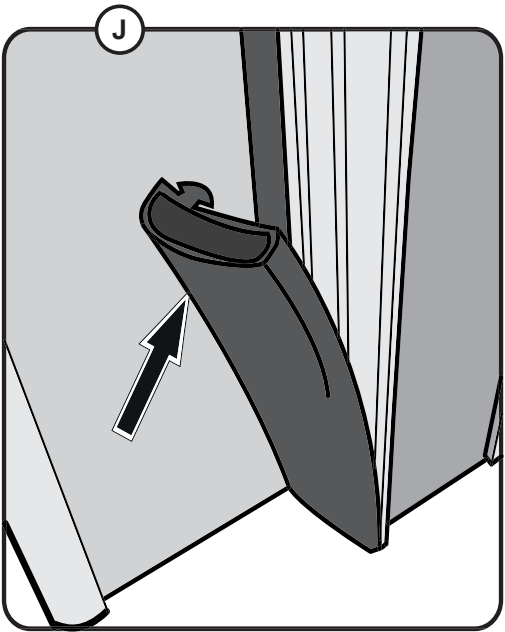

J. Finally install the seal. Start from the bottom up. Attach by pressing inwards.

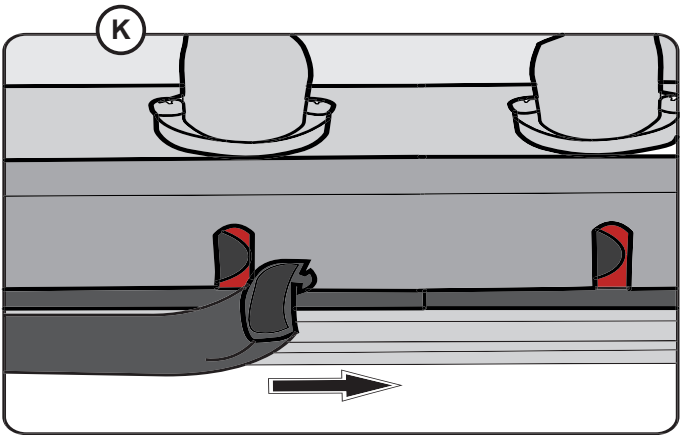

K. The seal shall be installed along with the whole doorframe

**This product is not originally  $\text{CE}$  certified. The complete installation must be  $\text{CE}$  approved by installer.**